

HOW TO INSTALL GLOSSWOOD PREFINISHED DESIGNER LINING AND FORM SERIES

Glosswood Designer Lining for walls and ceilings come sealed on four sides in the colour of your choice for easy installation. Our Designer Lining boards can be fixed to existing walls and ceilings (level and in good condition), plus rafters, joists, trusses, wall framing and battens attached to masonry walls. No sanding, varnishing or painting required.

WHAT YOU WILL NEED



Brad Nails
40 / 50mm

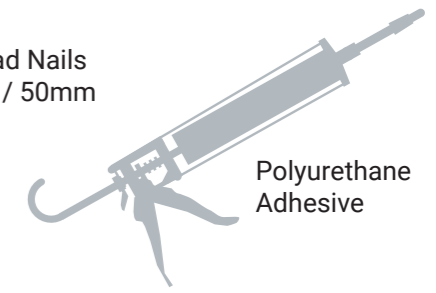

Decide on a horizontal or vertical pattern, then measure up to determine how many timber Designer Lining boards you will need. The Designer Lining Board is 91mm with a 81mm cover. Please note recommended batten spacing for these boards is 600mm.

Board Size	Length	Coverage Per Pack
91 x 26mm	3.6m	81mm
Square Edge Trim	3.6m	N/A

Designer Lining boards are sold by individual lengths

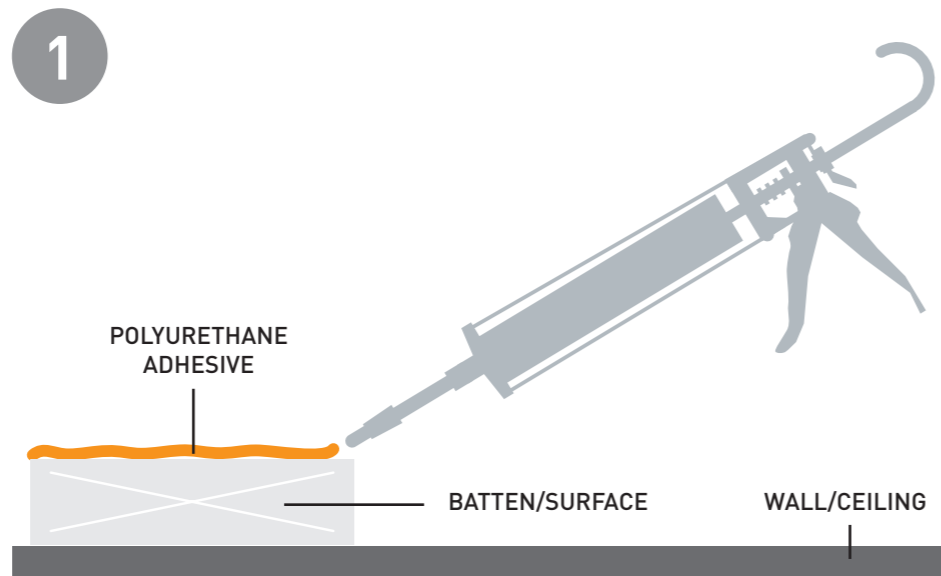

Apply polyurethane adhesive to batten/surface.

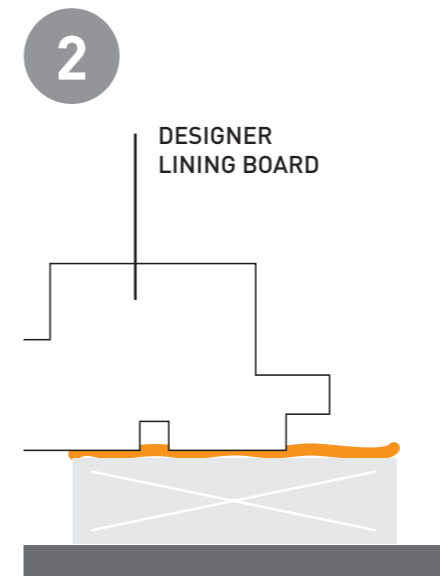

Place first lining board on batten/surface with tongue facing outwards.

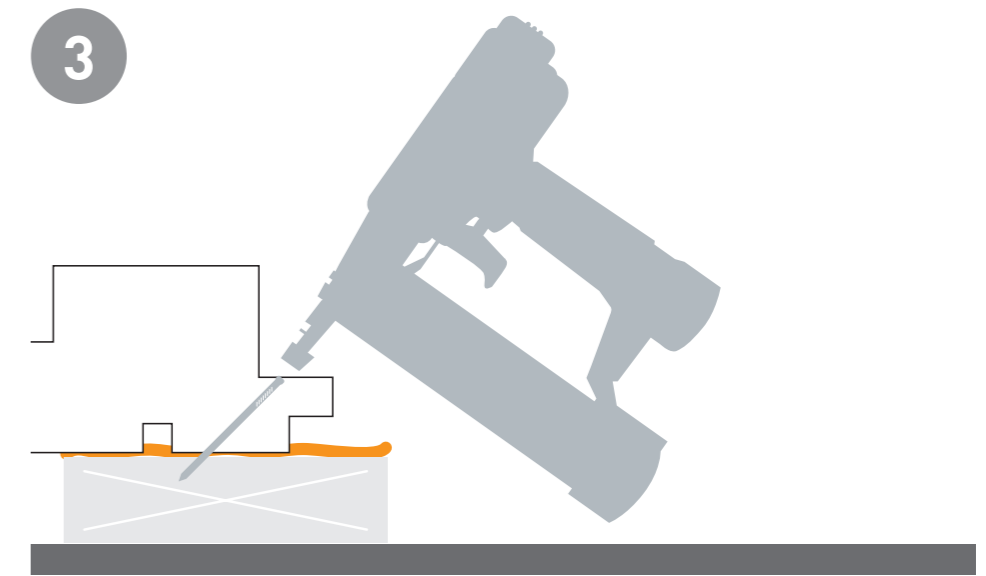

Nail through the protruding tongue on a 45-degree angle.

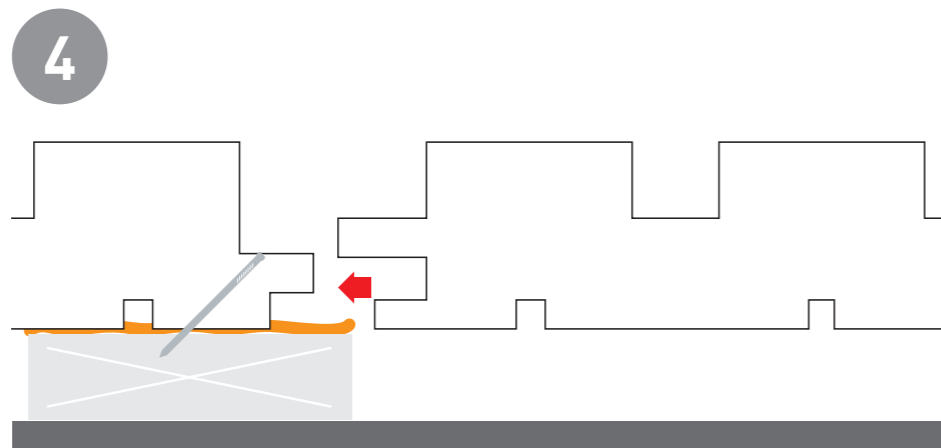

Slide in next lining board and continue with adhesive and nailing until you have lined your surface.

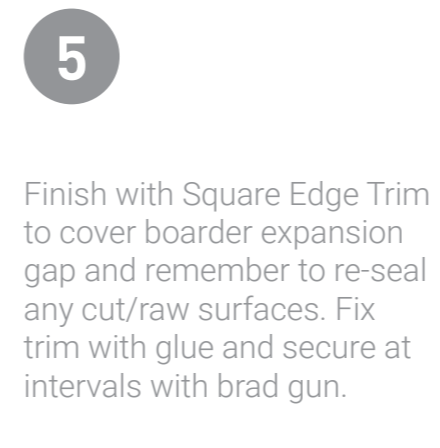

Finish with Square Edge Trim to cover boarder expansion gap and remember to re-seal any cut/raw surfaces. Fix trim with glue and secure at intervals with brad gun.



INSTALLATION: HORIZONTAL

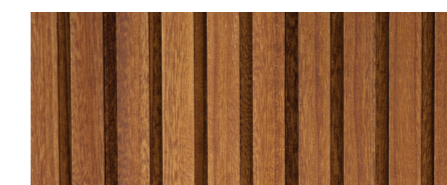

INSTALLATION: VERTICAL

INSTALLATION TIPS

Ensure a straight level surface is achieved.

Stagger the Boards so that there is not a straight line of end-matched boards.

Seal the ends of each cut length.

*Refer to Installation & Maintenance Guide before installing Glosswood